

1550

Webster City
Well
Varner

1600

Sdy
dol

1750

1800

~~1800~~
~~1800~~
~~1800~~

Dol
Dol, arg, ss, pt. dol

1850

Dol

ss
Dol, ss

1900

1950

1806
1817

Rose Jordan 1857-1858

2000

Field located 7-24-79
T89N-R25W-Sec 33
SESW NESE NW
Elev 1035
C A S
Bill Bunker
Dick Karsten

Changed by Dick Karsten
Nov 1979
to [NESE NW]
Elev 1037

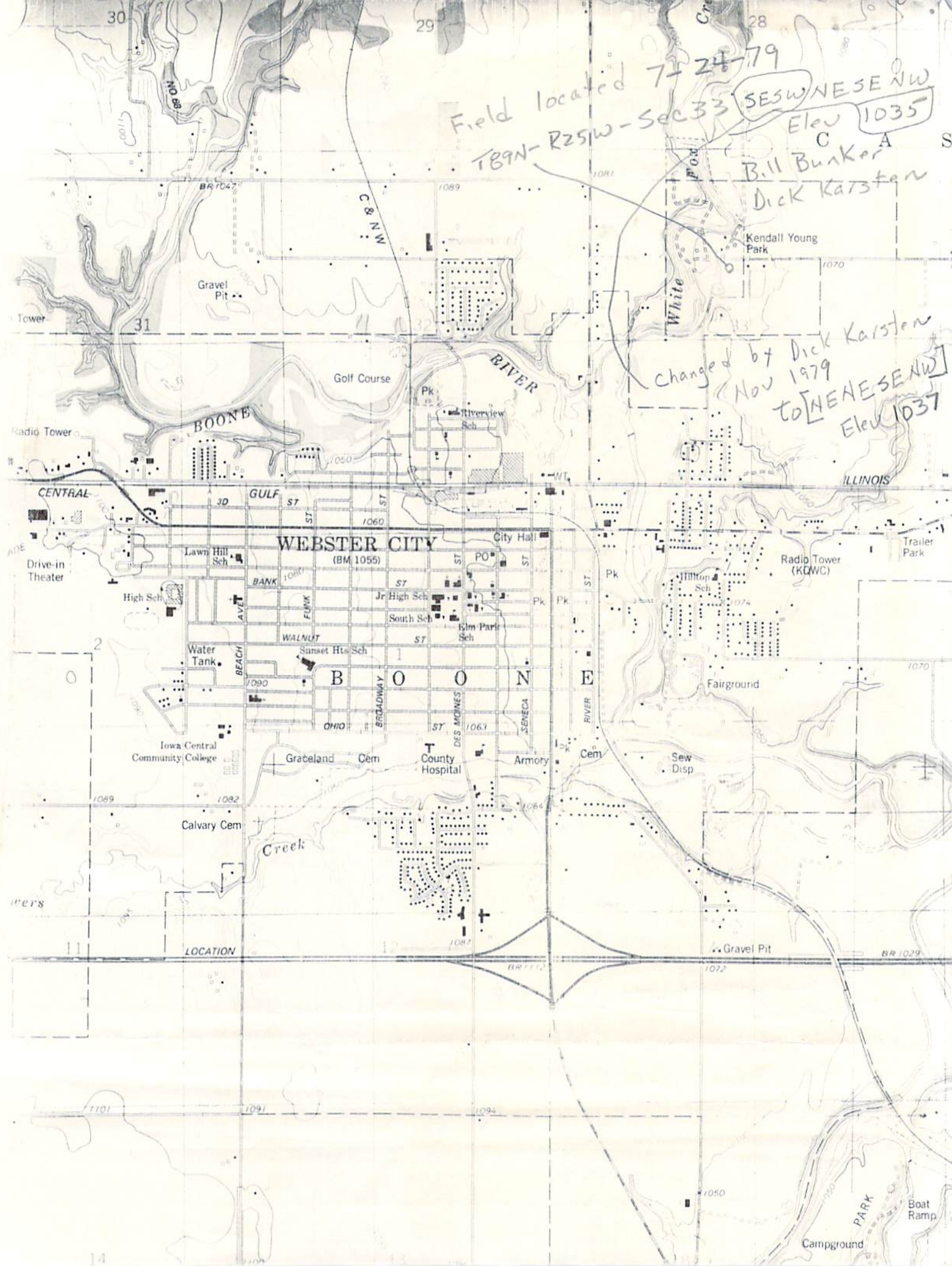

CASING

0-1505'

continuous string

16" & 20" with swedge

per Terry Nauman
Varnier Well Co.

D. Karsten 4/17/80

Dec 18, 1978

Based on the drillers log, and a study of well cuttings, I have concluded that in the Webster city well being drilled by Vamer well co. the top of the St. Peter sandstone is located at about 1392' to 1394'. The base of the St. Peter is located at about 1450-1455'

Michael J. Bounk

25409

HAMILTON

Name: City of Webster City - #3

Loc:

contr: Varner Well Co

Date: Oct-Nov-1978

T.V: 2000

Bedrock: 10'

Csg:

File Loc: PL9-812-813-814-815-816 + 817