

**Site identification**  
 Property Owner Plum River Golf Course Well Number 1  
 Address P.O. Box 167  
 Tenant Preston IA 52069  
 Well Depth 942' ft Date completed 8/30/98  
9/12/98

**Location** County Jackson County  
 \_\_\_\_\_ mi. N and \_\_\_\_\_ mi. E of intersection of \_\_\_\_\_ and \_\_\_\_\_  
N 1/4 of the NE 1/4 of the NW 1/4 of Sec 20 TWP 84N RNG 5 W  
 Show exact location of well in section grid with a dot (•). Sketch map of well location on property.

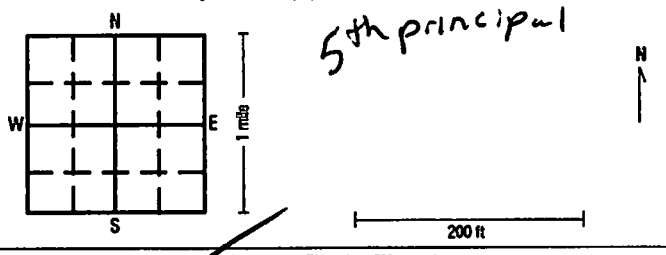

upland  hillside  valley Elevation (if known) \_\_\_\_\_

**Formation log**

From	To	Color	Hardness	Formation description
0	1			Top Soil
1	54	Tan		Fractured Rock
54	224	light brown Hard		limestone
224	424	Blue		shale
424	624	Gray Hard		limestone
624	740	Brown		limestone
740	745	Dark blue		limestone
745	752	Blue		shale
752	755	Tan		limestone
755	776	White		Sand Stone
776	780	Blue		shale
780	870	White		Sand Stone
870	932	Red White		Sand Stone
932	942	Tan		Sand Stone

use additional sheets as needed

**Remarks** (including depth of lost drilling fluids, materials, or tools)  
Large Fracture top to 265'

**Well use**

Domestic  Municipal  Commercial  
 Livestock  Public supply  Monitoring  
 Test well  Irrigation  Other \_\_\_\_\_ (explain)

**Drill method**  rotary  auger  cable other \_\_\_\_\_  
**Hole size**  
17 1/2 inch from 0 ft to 60 ft ~~3 1/2~~ inch from \_\_\_\_\_ ft to \_\_\_\_\_ ft  
13 inch from 60 ft to 755 8" inch from 755 ft to 942

Record all depth measurements from ground level (GL). Use (+) for above GL measurements.

**Casing** Drive shoe (yes/no) \_\_\_\_\_ Pitless adapter (yes/no) \_\_\_\_\_

Size (ID/OD)	Type / Wt	Depth top	Depth bottom	Amount (length)
<u>8" steel</u>	<u>.322</u>	<u>+1</u>	<u>755</u>	<u>756</u>
<u>6" steel</u>	<u>.280</u>	<u>753</u>	<u>942</u>	<u>189'</u>

**Perforated or slotted casing?** (yes/no) \_\_\_\_\_  
 Perforated / slotted from 942 ft to 858 ft  
 Perforated / slotted from \_\_\_\_\_ ft to \_\_\_\_\_ ft

**Casing grouted?** (yes/no) \_\_\_\_\_ Placement method Stringer

Type	Depth Top	Depth bottom	Amount (vol/wt)
<u>Concrete</u>	<u>0</u>	<u>755</u>	

**Well screen?** (yes/no) \_\_\_\_\_

Diameter	Slot size	Depth Top	Depth Bottom	Length	Material
	<u>0</u>				
	<u>0</u>				

Bottom capped (yes/no) \_\_\_\_\_ with \_\_\_\_\_  
 Seals / Packers (yes/no) \_\_\_\_\_ kind \_\_\_\_\_ depth \_\_\_\_\_ ft  
 Gravel packed (yes/no) \_\_\_\_\_ from \_\_\_\_\_ ft to \_\_\_\_\_ ft  
 type \_\_\_\_\_ amount \_\_\_\_\_

**Well developed?** (yes/no) \_\_\_\_\_  
 Explain tin lift  
 (pumped, airlifted, bailed) for \_\_\_\_\_ hrs at \_\_\_\_\_ GPM.

**Pump installed?** (yes/no) \_\_\_\_\_ Date \_\_\_/\_\_\_/98  
 Installer's name Northway Well  
 Type of pump \_\_\_\_\_ Depth to intake \_\_\_\_\_ ft  
 Pump diameter \_\_\_\_\_ Rated capacity \_\_\_\_\_ GPM

**Water information** Aquifer:  sand / gravel  limestone  sandstone  
 Main water-supply zone from 780 ft to 942 ft  seepage well  
 Static water level 40 ft (below / above) GL;  tape  airline  E-line  estimate  
 Pumping water level \_\_\_\_\_ ft below GL;  tape  airline  E-line  estimate  
 At yield of 1 GPM;  orifice  volumetric  estimate  
 Measurements taken at \_\_\_\_\_: \_\_\_\_\_ (AM / PM) Date 9 / 12 / 98

**Water quality test?** (yes/no) \_\_\_\_\_ Date tested \_\_\_/\_\_\_/\_\_\_  
 Tested by \_\_\_\_\_

Contractor Frazer Well Drilling INC  
 Address 10301 Feather Ridge Rd Tallville  
 Driller Frazer Certification no. \_\_\_\_\_